

## Safety & Operating Instructions

DE	Sicherheits- und Betriebsanweisungen
PL	Instrukcje dotyczące bezpieczeństwa i obsługi
CZ	Bezpečnostní a provozní pokyny
FR	Consignes de sécurité et d'utilisation
IT	Istruzioni per la sicurezza e l'uso
ES	Instrucciones de seguridad y funcionamiento
HU	Biztonsági és használati útmutató
DK	Sikkerheds- og betjeningsvejledning
FI	Turvallisuus- ja käyttöohjeet
NO	Sikkerhets- og bruksanvisning
NL	Veiligheids- en bedieningsinstructies
SE	Säkerhets- och bruksanvisningar
PT	Instruções de segurança e de funcionamento
SK	Bezpečnostné a prevádzkové pokyny
BG	Инструкции за безопасност и експлоатация
GR	Οδηγίες ασφαλείας και λειτουργίας
HR	Sigurnosne i upute za rad
LT	Saugos ir naudojimo instrukcijos
RO	Instrucțiuni de siguranță și operare
SL	Varnost in navodila za uporabo

## CRANE

<b>DE</b>	Produktname	Kran
<b>EN</b>	Product name	Crane
<b>PL</b>	Nazwa produktu	Dźwig
<b>CZ</b>	Název výrobku	Jeřáb
<b>FR</b>	Nom du produit	Grue
<b>IT</b>	Nome del prodotto	Gru
<b>ES</b>	Nombre del producto	Grúa
<b>HU</b>	Termék neve	Daru
<b>DA</b>	Produktnavn	Kran
<b>FI</b>	Tuotteen nimi	Nosturi
<b>NL</b>	Productnaam	Kraan
<b>NO</b>	Produktnavn	Kran
<b>SE</b>	Produktnamn	Kran
<b>PT</b>	Nome do produto	Guindaste
<b>SK</b>	Názov produktu	Žeriav
<b>BG</b>	Име на продукта	Кран
<b>EL</b>	Όνομα προϊόντος	Γερανός
<b>HR</b>	Naziv proizvoda	Dizalica
<b>LT</b>	Produkto pavadinimas	Kranas
<b>RO</b>	Numele produsului	Macara
<b>SL</b>	Ime izdelka	žerjav
<b>DE</b> Modell   <b>EN</b> Product model   <b>PL</b> Model produktu   <b>CZ</b> Model výrobku   <b>FR</b> Modèle   <b>IT</b> Modello   <b>ES</b> Modelo   <b>HU</b> Modell   <b>DA</b> Model   <b>FI</b> Tuotteen malli   <b>NL</b> Productmodel   <b>NO</b> Produktmodell   <b>SE</b> Produktmodell   <b>PT</b> Modelo do produto   <b>SK</b> Model   <b>BG</b> Модел на продукт   <b>EL</b> Μοντέλο προϊόντος   <b>HR</b> Model proizvoda   <b>LT</b> : Gaminio modelis   <b>RO</b> : Model de produs   <b>SL</b> : Model izdelka		MSW-PTC-900
<b>DE</b> Hersteller   <b>EN</b> Manufacturer   <b>PL</b> Producent   <b>CZ</b> Výrobce   <b>FR</b> Fabricant   <b>IT</b> Produttore   <b>ES</b> Fabricante   <b>HU</b> Termelő   <b>DA</b> Producent   <b>FI</b> Valmistaja   <b>NL</b> Producent   <b>NO</b> Produsent   <b>SE</b> Tillverkare   <b>PT</b> Fabricante   <b>SK</b> Výrobca   <b>BG</b> Производител   <b>EL</b> Κατασκευαστής   <b>HR</b> Proizvođač   <b>LT</b> Gamintojas   <b>RO</b> Producător   <b>SL</b> Proizvajalec		expondo Polska sp. z o.o. sp. k.
<b>DE</b> Anschrift des Herstellers   <b>EN</b> Manufacturer Address   <b>PL</b> Adres producenta   <b>CZ</b> Adresa výrobce   <b>FR</b> Adresse du fabricant   <b>IT</b> Indirizzo del produttore   <b>ES</b> Dirección del fabricante   <b>HU</b> A gyártó címe   <b>DA</b> Producentens adresse   <b>FI</b> Valmistajan osoite   <b>NL</b> Adres producent   <b>NO</b> Produsentens adresse   <b>SE</b> Tillverkarens adress   <b>PT</b> Endereço do fabricante   <b>SK</b> Adresa výrobce   <b>BG</b> Адрес на производителя   <b>EL</b> : Διεύθυνση κατασκευαστή   <b>HR</b> Adresa proizvođača   <b>LT</b> Gamintojo adresas   <b>RO</b> Adresa producătorului   <b>SL</b> Naslov proizvajalca		ul. Nowy Kisielin – Innowacyjna 7, 66-002 Zielona Góra   Poland, EU



This User Manual has been translated using machine translation. We have made every effort to ensure the translation is accurate, but please note that automated translations are not perfect and are not meant to replace human translators. The official version of the User Manual is in English. Any differences between the translated version and the original English are not legally binding. If you have any questions about the accuracy of the translation, please refer to the English version, which is the official reference. More language versions are available upon request via [info@expondo.com](mailto:info@expondo.com).

## Technical data

Parameter description	Parameter value
Product name	Crane
Model	MSW-PTC-900
Max. lifting capacity [kg]	900
Max. lifting height [mm]	1800
Dimensions [width x length x height; mm]	270 x 1260 x 1360
Weight [kg]	52

### 1. General description

The user manual is designed to assist in the safe and trouble-free use of the device. The product is designed and manufactured in accordance with strict technical guidelines, using state-of-the-art technologies and components. Additionally, it is produced in compliance with the most stringent quality standards.

**DO NOT USE THE DEVICE UNLESS YOU HAVE THOROUGHLY READ AND UNDERSTOOD  
THIS USER MANUAL.**

To increase the product life of the device and to ensure trouble-free operation, use it in accordance with this user manual and regularly perform maintenance tasks. The technical data and specifications in this user manual are up to date. The manufacturer reserves the right to make changes associated with quality improvement. The device is designed to reduce noise emission risks to a minimum, taking into account technological progress and noise reduction opportunities.

#### Legend



The product satisfies the relevant safety standards.



Read instructions before use.



The product must be recycled.



**WARNING!** or **CAUTION!** or **REMEMBER!** Applicable to the given situation.  
(general warning sign)



Wear protective gloves.



Wear head and face protection.



Wear foot protection.



ATTENTION! Suspended weight!



ATTENTION! Hand crush hazard!



PLEASE NOTE! Drawings in this manual are for illustration purposes only and in some details may differ from the actual product.

## 2. Usage safety



**ATTENTION!** Read all safety warnings and all instructions. Failure to follow the warnings and instructions may result in serious injury or even death.

The terms "device" or "product" are used in the warnings and instructions to refer to Crane.

### 2.1. Safety in the workplace

- a) Keep the work area tidy and well-lit. Disorder or poor lighting can lead to accidents. Be careful, watch what you are doing, and use common sense when working with the device.
- b) If in doubt about whether the device is working properly, contact the manufacturer's service.
- c) Repairs to the device may only be carried out by the manufacturer's service. Do not attempt repairs yourself!
- d) No children or unauthorized persons are allowed in the work area. (Lack of attention may result in loss of control over the device).
- e) Check the condition of the safety stickers regularly. Replace them if they become illegible.
- f) Keep these instructions for future reference. If the device is to be passed on to third parties, the instructions for use must be provided along with the device.
- g) Keep packaging parts and small assembly components out of the reach of children.
- h) Keep the device away from children and animals.
- i) When using this device together with other devices, the other instructions for use must also be followed.



**Remember!** When using the device, protect children and other bystanders.

### 2.2. Personal safety

- a) Do not operate the device if you are tired, ill or under the influence of alcohol, drugs or medication which might impair your ability to operate the device.
- b) The device may only be operated by persons who are physically fit, capable of handling the device and who have been adequately trained, who have read these instructions and have received training in health and safety.
- c) The device is not intended to be used by persons (including children) with reduced mental, sensory or intellectual functions or lack of experience and/or knowledge, unless they are supervised by a person responsible for their safety or have been given instructions by them on how to operate the device.
- d) Be careful and use common sense when operating the device. A short moment of distraction during operation may lead to serious personal injury.
- e) Use the required personal protective equipment when working with the device specified in section 1 of the explanation of symbols. The use of appropriate, approved personal protective equipment reduces the risk of injury.
- f) Do not overestimate your capabilities. Maintain body balance at all times during operation. This allows for better control of the device in unexpected situations.
- g) Do not wear loose clothing or jewellery. Keep hair, clothing and gloves away from moving parts. Loose clothing, jewellery or long hair can be caught by moving parts.
- h) The device is not a toy. Children should be supervised to ensure that they do not play with the device.

## 2.3. Safe device use

- a) Read carefully and understand all ASSEMBLY AND OPERATION INSTRUCTIONS before operating. Failure to follow the safety rules and other basic safety precautions may result in serious personal injury.
- b) Read and understand all instructions. Failure to follow all instructions listed below may result in serious injury.
- c) Do not allow persons to operate or assemble this product until they have read this manual and have developed a thorough understanding of how the product works.
- d) The warnings, cautions, and instructions discussed in this instruction manual cannot cover all possible conditions or situations that could occur. It must be understood by the operator that common sense and caution are factors that cannot be built into this product, but must be supplied by the operator.
- e) Do not overload the device. Use tools that are suitable for the given application. A correctly selected device ensures better and safer performance of work.
- f) Keep unused devices out of the reach of children and anyone not familiar with the device or these instructions. Devices are dangerous in the hands of inexperienced users.
- g) Keep the device in good working order. Before each use, check for general damage or damage to moving parts (cracks in components or any condition that may affect safe operation). If damaged, have the device repaired before use.
- h) Keep the device out of the reach of children.
- i) Repair and maintenance of the device should be carried out by qualified persons using only original spare parts. This will ensure safe use of the device.
- j) Do not remove factory-installed covers or loosen any screws to maintain the designed operational integrity of the device.
- k) When transporting the device from storage to the place of use, follow the health and safety regulations applicable in the country where the device is used.
- l) It is forbidden to move, shift or rotate the device during operation.
- m) Clean the device regularly to prevent the permanent accumulation of dirt.
- n) The device is not a toy. Cleaning and maintenance must not be performed by children without adult supervision.
- o) It is forbidden to tamper with the device in order to change its parameters or construction.
- p) Keep the device away from sources of fire and heat.
- q) Do not overload the device.
- r) Avoid sudden lowering and swinging of the suspended load, especially when moving the device.
- s) Use ropes or chains which can carry a load that is heavier than the load being lifted.
- t) Do not use the device if there is no oil in the cylinder or its amount is insufficient.
- u) Watch out for your legs, hands and fingers when working with the device.



**ATTENTION! Despite the safe design of the device and its protective features, and despite the use of additional elements protecting the operator, there is still a slight risk of accident or injury when using the device. Stay alert and use common sense when using the device.**

## 3. Use guidelines

The crane is designed for lifting and transporting heavy parts, such as engines and gearboxes, and for garage operations, including the disassembly and assembly of heavy vehicle components.

**The user is liable for any damage resulting from unintended use of the device.**

### 3.1. Device description

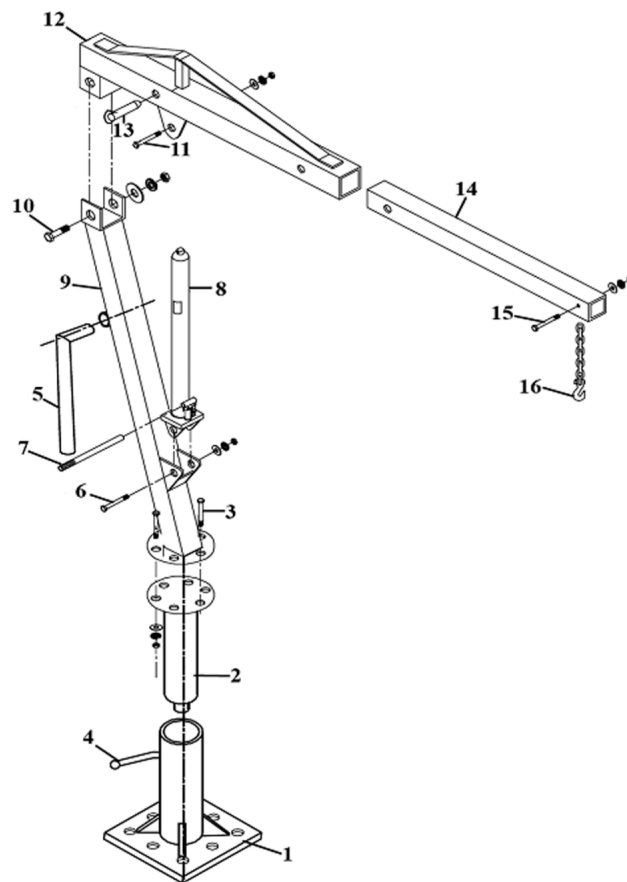

Item	Description	Item	Description
1	Base	9	Post
2	Wheel Hub	10	Bolt M16x90
3	Bolt M14x35	11	Bolt M16x80
4	Bolt M14x25	12	Boom
5	Wheel Working Arm	13	Pin
6	Bolt M16x80	14	Boom Extension
7	Jack Handle	15	Bolt M14x80
8	Jack (3ton)	16	Hook And Chain

### 3.2. Device use



#### WARNING

- DO NOT use motor oil in the crane.
- ONLY use anti-foaming jack oil.
- Always use high-grade hydraulic jack oil.
- DO NOT use hydraulic brake fluid, alcohol, glycerine, detergent, motor oil, or dirty oil.
- Using non-recommended fluids can damage the crane.
- Avoid mixing different types of fluids. Never use brake fluid, turbine oil, transmission fluid, motor oil, or glycerine. Incorrect fluids can cause premature failure and sudden loss of load.
- Dispose of hydraulic fluid in accordance with local regulations.

#### 1. HYDRAULIC ENGINE CRANE – USE AND CARE

- 1) Do not modify the crane in any way. Unauthorized modifications can impair functionality, reduce safety, and shorten the equipment's lifespan.
- 2) Inspect for damage or wear before each use. Broken parts affect crane operation and should be repaired or replaced immediately.
- 3) Store the crane securely when not in use. Keep it out of reach of children and inspect it before reuse.
- 4) Not suitable for children or individuals with reduced mental capacity.
- 5) Do not use under the influence of drugs or alcohol.
- 6) Ensure bystanders, especially children, remain at a safe distance when operating the crane.

#### 2. INSPECTION

- 1) Carefully inspect the crane before each use. Check for damage, excessive wear, or missing parts.
- 2) Do not operate the crane unless it is properly lubricated.
- 3) Using a poorly maintained or unlubricated crane may cause serious injury.
- 4) Inspect the work area before using the crane. Ensure it is clear of hazards.

#### 3. OPERATING INSTRUCTIONS – BEFORE USE

- 1) Read the owner's manual thoroughly to understand the product and potential hazards.
- 2) Perform the air purge procedure. (Refer to system purge instructions.)

- 3) Ensure the pump operates smoothly before putting it into service.
- 4) Inspect all components before each use. Do not use the crane if any part is bent, broken, or cracked.

**CAUTION**

- Air may enter the hydraulic system, causing poor lifting performance.
- To purge air from the system:
  - 1) Fully open the release valve (turn the handle counterclockwise).
  - 2) While holding the boom down, rapidly operate the pump handle several times.

**4. How the Long Ram Operates**

- 1) With the release valve closed:
  - Upward stroke of the handle draws oil from the reservoir into the plunger cavity.
  - Hydraulic pressure holds the valve closed, keeping oil inside.
  - Downward stroke releases oil into the cylinder, forcing the ram out. This raises the hydraulic ram.
  - When the ram reaches maximum extension, excess oil returns to the reservoir to prevent overextension.
- 2) Opening the release valve allows oil to flow back into the reservoir, lowering the hydraulic ram.

### 3.3. Cleaning and maintenance

Proper use and maintenance will extend the lifespan of your equipment. Follow these instructions carefully to keep it in good working condition.



**WARNING!** Never perform maintenance while the crane is under a load.

**1. Inspection**

- Inspect the product before each use for damage, wear, broken, or missing parts (e.g., pins).
- Ensure all components function properly.
- Follow lubrication and storage guidelines for optimal performance.

**2. Binding**

- If the crane binds while under a load, use equal or larger capacity equipment to lower the load safely.
- After unbinding:
  - Clean, lubricate, and test the equipment.
  - Rust, dirt, or worn parts may cause binding—clean and lubricate as needed.
  - Test by lifting without a load.
  - If binding persists, contact Customer Service.

**3. Cleaning**

- If moving parts are obstructed, use a cleaning solvent or degreaser.
- Remove rust using a penetrating lubricant.

#### **4. Lubrication**

- Lubrication is essential for safe operation. Lack of lubrication can cause poor performance and damage.
- Some parts are not self-lubricating—inspect before use and lubricate as needed.
- After cleaning, apply light penetrating oil or lubricating spray.

##### **Guidelines for lubrication**

- Use a high-quality lubricant on all moving parts.
- For light-duty use → Lubricate once a month.
- For heavy or continuous use → Lubricate weekly. Never use sandpaper or abrasive materials on any surface.

#### **5. Rust Prevention**

- Check daily for rust or corrosion on rams and pump plungers.
- Without a load, raise the equipment fully and inspect under and behind lifting points.
- Clean rust immediately if detected.

### **3.4. Storage**

1. Lower the lifting arm.
2. Place the handle in the upright position.
3. Store in a dry location (indoor storage recommended).
4. If stored outdoors, lubricate all parts before and after use to prevent corrosion and ensure good condition.

# Environmental and disposal information

Producer to customer

Dear Sir or Madam,

Let's take care of the environment! The product you own should not be disposed of with household waste. According to applicable regulations (Directive 2012/19/EU and other local regulations), used equipment must be taken to designated collection points for proper disposal and recycling.



## How to Handle the Product at the End of Its Lifecycle?

- 1. Electrical and Electronic Equipment:** Products marked with the crossed-out wheeled bin symbol must not be disposed of with household waste. You can:
  - Take it to your local collection point for electrical and electronic equipment.
  - Use the “one-for-one” system (returning the old device when purchasing a new one, if available in your region).
- 2. Batteries and Accumulators:** If the product contains batteries, remove them before recycling and take them to designated battery collection points.
- 3. Packaging Materials:** Packaging, such as cardboard or plastic, should be sorted and placed in recycling bins.

## Why is This Important?

Proper disposal of equipment and packaging materials:

- Protects the environment from harmful substances.
- Enables the recovery of valuable resources.
- Reduces the amount of waste sent to landfills.

## Where to Find Information?

Information about waste collection points can be found on local authorities' websites or through your recycling service provider. If needed, contact our customer service team, who will gladly provide further details.

Thank you for your care for the environment and commitment to recycling!

## Contact

expondo Polska sp. z o.o. sp. k.  
ul. Nowy Kisielin – Innowacyjna 7  
66-002 Zielona Góra | Poland, EU  
info@expondo.com