



**MONOLITH**

DESIGN AND TECHNOLOGICAL RESEARCH FOR WATER

FAUCETS FOR LARGE INSTALLATIONS

# **ZEUS001/PM**

ELECTRONIC SINK TAP  
PREMIUM LINE  
POWERED BY BATTERY (4x1,5V AA)  
WITH MECHANICAL PRE-MIXER



**USER AND MAINTENANCE MANUAL**

MONOLITH srl Thanks you to buy a product from our gamma and invites you to read this manual which contains all the necessary information for a correct use of the item.

The user is required to reading the same before the use and to an use in accordance with the warnings contained in it.

The User and Maintenance manual has to be available for a correct conservation.

MONOLITH srl reserves the right to make variations or changes to this manual without obligation to notice it to the customers.

#### DESCRIPTION:

Electronic sink tap powered by LITHIUM batteries type AA 4x1,5V. Water distribution through activation of sensor infrared fixed fire.

#### OPERATING:

The Infrared Sensor (C) (see pict. 1) recognizes the presence of the hands and begins to dispense water until it is more present or until the maximum closing time elapses (ANTI VANDALIC SYSTEM).

If The system detects an object for about 1 minute, the system automatically closes the water supply until the object is removed.

The battery exhaustion is indicated by the red flashing light of the LED, the solenoid valve closes and the dispensing system stops waiting for the batteries to be replaced.

**The operation of the faucet is guaranteed only with water without impurities.**

**Install the interception taps with filter (not supplied) in the line, to preserve the functionality of the solenoid valve and for any maintenance operations.**

**Use only LITHIUM batteries for greater durability and efficiency of the product.**



#### INSTALLATION INSTRUCTIONS:

**Always bleed the piping before installation and at every temporary closure of the system.**

- 1) Close the water supply.
- 2) Pierce the sink  $\varnothing 33$ .
- 3) Manually Tighten the tie rod (2) to the base of the already assembled tap (1). Insert The sealing base (3) and O-Ring (4) into the already assembled tap (1).
- 4) Place the tap on the hole  $\varnothing 33$  previously made in the sink, passing the hose (5) and the cable (A) inside it.
- 5) Fix the faucet to the sink by inserting under the sink the shaped gasket (7) then the metal Insert (8) and tighten the hexagonal nut (6) on the tie rod (2). Use a clamping wrench SW11.
- 6) Connect the flexible (5) to the fitting (9).
- 7) Connect the mechanical pre-mixer (10) to the fitting (9) after insert the gasket (11).
- 8) Connect the hoses (12) to the mechanical pre-mixer (11).
- 9) Connect the hoses (5) to the water mains.
- 10) Fasten the battery holder box (B) to the wall (under the sink) using the appropriate screws and plugs (not supplied) after drilling the wall from  $\varnothing 6$ , making sure that the cable outlet is facing downwards as in pic. 1. Place the battery box in the safe area away from possible damages.
- 11) Insert The 4 lithium batteries into the box making sure that the + and - poles are correctly matched.
- 12) Connect the cable (A) to the battery holder box (B)
- 13) The system is set by default as per product specifications with a closing delay (comfort time) of 6 sec and a self-closing for blinding sensor (vandal resistant) of 1 min.

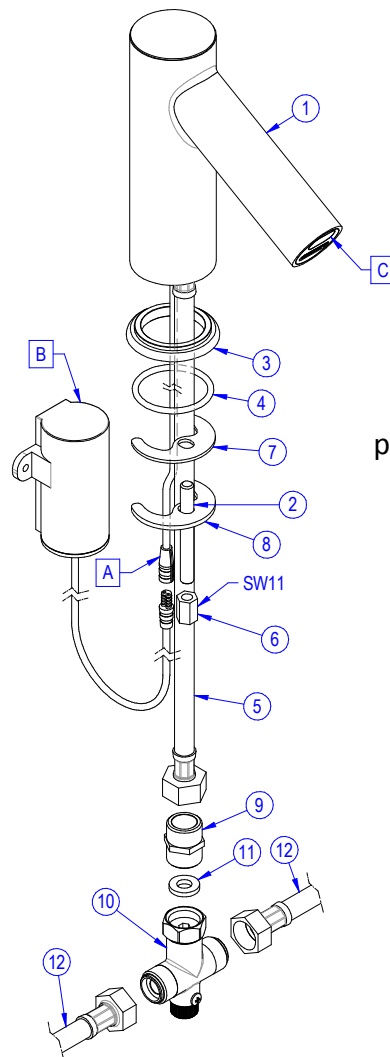

pic. 1



**Important! The installation operations must be carried out by suitably trained personnel taking into account the information given by this manual.**

**TECHNICAL INFORMATION:**

POWER	LITHIUM BATTERY AA 4x1,5V
MIN/MAX PRESSURE OF USE	0,5÷8 bar (recommended 3 bar)
MAXIMUM TEMPERATURE OF USE	60°C
SENSOR DISTANCE	10 cm ± 2 cm
WATER FLOW	6 L/min con 3 bar of pressure
FLEXIBLE CONNEXION	G 1/2" Female
FLEXIBLE LENGTH	40 cm
NON RETURN VALVE	Included
LOW BATTERY SIGNAL	yes
ANTI VANDALIC SYSTEM	yes

**MAIN DATA SYSTEM**

Field sensitivity	100mm ± 20mm (Non-adjustable)
Auto-closing valve	The ignition, avoiding water escaping.
Maximum opening delay	400msec (depending on the pressure)
Closure delay (Comfort time)	Standard: ~6 sec ± 1 sec
Auto-closure for blinding sensor (Antivandalic)	Standard: ~1min
Anti-legionella distribution	Automatic Operation after 24 hours of Unuse
Tensione delle batterie sotto 5,2Vdc	The system not allows the valve's opening
RED Led for low battery status signal. For each action on user request, if the battery is no longer able to activate the valve, the LED flashes.	
LED on fixed at start to show the correct connection. At each opening and closing control valve a short flashing of the LED. In case of almost discharged batteries, indication with 3 flashes. In case of exhausted batteries indication with 6 flashes.	
Reverse polarity Protection.	
Algorithmic Correction of sensor response to the sudden variation of ambient temperature.	
The sensor is equipped with a system of minimization of electromagnetic disturbances.	

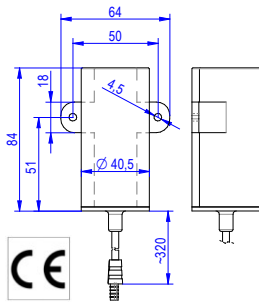

**MAIN DATA BATTERY HOLDER**

Supported batteries	4 lithium primary batteries type AA 1,5V
Protection class	IPX5

**WARNINGS:**

- For use with water only
- Only for indoor use
- Do not use toxic or abrasive products to clean the faucet

**MAINTENANCE:**

**Important! Any maintenance operation must be carried out by suitably trained personnel taking into account the information given by this manual.**

- Periodically Wipe the sensor with a mild damp cloth.
- Periodically Clean the filter of the shut-off tap in the supply line.

**DISPOSAL OF POLLUTING MATERIAL:**

In case of maintenance or demolition of the product, the parts of which it is composed must be entrusted to companies specialized in the disposal and recycling of industrial waste, in transposition of the European Directive 2012/19/EU (WEEE) concerning the disposal Electrical and electronic equipment and, in particular:

**-DISPOSAL OF THE PACKAGING:**

The packaging consists of biodegradable cardboard that can be delivered to companies for the normal recovery of cellulose.

**-DISPOSAL OF METAL PARTS:**

The metallic parts are recoverable from the companies specialized in the metal scrapping sector.

**-DISPOSAL OF FURTHER PARTS:**

Further parts such as pipes, rubber seals, plastic parts, electrical and electronic parts are to be entrusted to companies specialized in the disposal of industrial waste.

**WARRANTY:**

The duration of the warranty lasts 24 months from the date of purchase.

Any tampering or modifications to the product will invalidate any warranty request from the Customer.

All parts which may be defective due to failure to observe the operating instructions, incorrect installation or maintenance, maintenance operations carried out by unauthorized personnel, transport damages, are Not covered by warranty, or circumstances which, however, cannot be traced back to manufacturing defects.

The manufacturer declines all responsibility for any damage that may, directly or indirectly, result in persons and/or things as a result of failure to comply with all the prescriptions indicated in the following Instruction Manual and concerning, Especially, the warnings regarding installation, use and maintenance.

**FAILURE TO COMPLY WITH THE INSTRUCTIONS CONTAINED IN THIS BOOKLET IMPLIES THE FORFEITURE OF THE GUARANTEE.**

**CE DECLARATION OF CONFORMITY:**

The supplier: **Monolith S.r.l.** - Via dell'Artigiano, 8/F-8/G - 31050 Monastier di Treviso (TV) - ITALY  
Tel. +39 0422 842157 - Fax +39 0422 708978 - E-mail: [info@monolithsrl.com](mailto:info@monolithsrl.com) - [www.monolithsrl.com](http://www.monolithsrl.com)

Declares under its sole responsibility that the faucet model **ZEUS001**

**Complies with ROHS II 2011/65/EU and 2015/863/EU; 2014/35/EU; 2014/30/EU directives.**

The person authorized to form the technical dossier is Mr. Basso Davide as Legal Representative of the company.

Monastier di Treviso, 05.04.19

**BASSO DAVIDE**