



USER MANUAL

BEDIENUNGSANLEITUNG
INSTRUKCJA OBSŁUGI
NÁVOD K POUŽITÍ
MANUEL D'UTILISATION
ISTRUZIONI PER L'USO
MANUAL DE INSTRUCCIONES
HASZNÁLATI ÚTMUTATÓ BRUGSANVISNINGENKEL KÄYTTÖOHJE GEBRUIK
SAANWIJZING
BRUKSANVISNING
INSTRUÇÕES DE UTILIZAÇÃO
POUŽÍVATEĽSKÁ PRÍRUČKA
РЪКОВОДСТВО ЗА УПОТРЕБА
ΟΔ ΗΓΙΕΣ ΧΡΗΣΗΣ
UPUTE ZA UPORABU
NAUDOJIMO INSTRUKCIJA
MANUAL DE UTILIZARE
NAVODILA ZA UPORABO

TABLE SAW

DE	Produktname	Formatkreissäge
EN	Product name	Table saw
PL	Nazwa produktu	Piła stołowa
CZ	Název výrobku	Kotoučová pila
FR	Nom du produit	Scie circulaire sur table
IT	Nome del prodotto	Sega da banco
ES	Nombre del producto	Sierra de mesa
HU	Termék neve	Asztali körfűrész
DA	Produktnavn	Bordcirkelsav
FI	Tuotteen nimi	Pöytäpyörösaha
NL	Productnaam	Cirkelzaag
NO	Produktnavn	Bordsirkelsag
SE	Produktnamn	Bordcirkelsåg
PT	Nome do produto	Serra de mesa
SK	Názov produktu	Kotúčová píla
BG	Име на продукта	Циркулярен трион
EL	Όνομα προϊόντος	Πριστήρι τραπέζι
HR	Naziv proizvoda	Stolna kružna pila
LT	Produkto pavadinimas	Stalinis diskinis pjūklas
RO	Numele produsului	Ferăstrău circular de masă
SL	Ime izdelka	Namizna krožna žaga
DE Modell EN Product model PL Model produktu CZ Model výrobku FR Modèle IT Modello ES Modelo HU Modell DA Model FI Tuotteen malli NL Productmodel NO Produktmodell SE Produktmodell PT Modelo do produto SK Model BG Модел на продукт EL Μοντέλο προϊόντος HR Model proizvoda LT : Gaminio modelis RO : Model de produs SL : Model izdelka		MSW-TSA-2400A
DE Hersteller EN Manufacturer PL Producent CZ Výrobce FR Fabricant IT Produttore ES Fabricante HU Termelő DA Producent FI Valmistaja NL Producent NO Produsent SE Tillverkare PT Fabricante SK Výrobca BG Производител EL Κατασκευαστής HR Proizvođač LT Gamintojas RO Producător SL Proizvajalec		expondo Polska sp. z o.o. sp. k.
DE Anschrift des Herstellers EN Manufacturer Address PL Adres producenta CZ Adresa výrobce FR Adresse du fabricant IT Indirizzo del produttore ES Dirección del fabricante HU A gyártó címe DA Producentens adresse FI Valmistajan osoite NL Adres producent NO Produsentens adresse SE Tillverkarens adress PT Endereço do fabricante SK Adresa výrobcu BG Адрес на производителя EL : Διεύθυνση κατασκευαστή HR Adresa proizvođača LT Gamintojo adresas RO Adresa producătorului SL Naslov proizvajalca		ul. Nowy Kisielin – Innowacyjna 7, 66-002 Zielona Góra Poland, EU



This User Manual has been translated using machine translation. We have made every effort to ensure the translation is accurate, but please note that automated translations are not perfect and are not meant to replace human translators. The official version of the User Manual is in English. Any differences between the translated version and the original English are not legally binding. If you have any questions about the accuracy of the translation, please refer to the English version, which is the official reference. More language versions are available upon request via info@expondo.com.

Technical data

Parameter description	Parameter value
Product name	Table saw
Model	MSW-TSA-2400A
Rated voltage [V~, N] / frequency [Hz]	400, 3 / 50
Rated power [W]	1100
Rated no load speed [rpm]	2850
Weight [kg]	80

1. General description

The user manual is designed to assist in the safe and trouble-free use of the device. The product is designed and manufactured in accordance with strict technical guidelines, using state-of-the-art technologies and components. Additionally, it is produced in compliance with the most stringent quality standards.

DO NOT USE THE DEVICE UNLESS YOU HAVE THOROUGHLY READ AND UNDERSTOOD THIS USER MANUAL.

To increase the product life of the device and to ensure trouble-free operation, use it in accordance with this user manual and regularly perform maintenance tasks. The technical data and specifications in this user manual are up to date. The manufacturer reserves the right to make changes associated with quality improvement. The device is designed to reduce noise emission risks to a minimum, taking into account technological progress and noise reduction opportunities.

Legend



The product satisfies the relevant safety standards.



Read instructions before use.



The product must be recycled.



WARNING! or **CAUTION!** or **REMEMBER!** Applicable to the given situation.
(general warning sign)



Use ear protection. Exposure to loud noise may result in hearing loss.



Wear protective goggles.



Wear foot protection.



Wear a face shield.



ATTENTION! Electric shock warning!



ATTENTION! Loud noise warning!



ATTENTION! Rotating parts, entanglement hazard!



ATTENTION! Hand crush hazard!



Emergency stop!



PLEASE NOTE! Drawings in this manual are for illustration purposes only and in some details may differ from the actual product.

2. Usage safety



ATTENTION! Read all safety warnings and all instructions. Failure to follow the warnings and instructions may result in electric shock, fire and/or serious injury or even death.

The terms "device" or "product" are used in the warnings and instructions to refer to:

Table saw

2.1. Electrical safety

- a) The plug must fit the socket. Do not modify the plug in any way. Using original plugs and matching sockets reduces the risk of electric shock.
- b) Avoid touching earthed elements such as pipes, heaters, boilers and refrigerators. There is an increased risk of electric shock if the earthed device is exposed to rain, comes into direct contact with a wet surface or is operating in a damp environment. Water getting into the device increases the risk of damage to the device and of electric shock.
- c) Do not touch the device with wet or damp hands.
- d) Use the cable only for its designated use. Never use it to carry the device or to pull the plug out of a socket. Keep the cable away from heat sources, oil, sharp edges or moving parts. Damaged or tangled cables increase the risk of electric shock.
- e) If working with the device outdoors, make sure to use an extension cord suitable for outdoor use. Using an extension cord suitable for outdoor use reduces the risk of electric shock.
- f) If using the device in a damp environment cannot be avoided, a residual current device (RCD) should be applied. The use of an RCD reduces the risk of electric shock.
- g) Do not use the device if the power cord is damaged or shows obvious signs of wear. A damaged power cord should be replaced by a qualified electrician or the manufacturer's service centre.
- h) To avoid electric shock, do not immerse the cord, plug or device in water or other liquids. Do not use the device on wet surfaces.
- i) **ATTENTION! DANGER TO LIFE!** While cleaning, never immerse the device in water or other liquids.

- j) Do not use in very humid environments or in the direct vicinity of water tanks.
- k) Prevent the device from getting wet. Risk of electric shock!
- l) The main power cable plug must be connected according to the appropriate electrical installation requirements and must include an earth lead (or a directly earthed conductor for 380V). It is highly recommended that qualified personnel handle the electrical connections.

2.2. Safety in the workplace

- a) Make sure the workplace is clean and well lit. A messy or poorly lit workplace may lead to accidents. Try to think ahead, observe what is going on and use common sense when working with the device.
- b) Keep the floor around the machine clean and free of scrap material, sawdust, oil, and other liquids to minimize the risk of tripping or slipping. Ensure the table is free of scrap, foreign materials, and tools before starting to cut. We recommend the use of anti-skid floor strips in the operator's standing area and marking off the machine's work area.
- c) Do not use the device in a potentially explosive environment, for example in the presence of flammable liquids, gases or dust. The device generates sparks which may ignite dust or fumes.
- d) If you discover damage or irregular operation, immediately switch the device off and report it to a supervisor without delay.
- e) If you are unsure about whether the product is operating correctly or if you find damage, please contact the manufacturer's service centre.
- f) Only the manufacturer's service centre may make repairs to the product. Do not attempt to make repairs yourself!
- g) In case of fire, use a powder or carbon dioxide (CO₂) fire extinguisher (one intended for use on live electrical devices) to put it out.
- h) Children or unauthorised persons are forbidden to enter a work station. A distraction may result in loss of control over the device.
- i) Use the device in a well-ventilated space.
- j) The device produces dust and debris during operation. It is important to protect bystanders from their harmful effects. Some dust created by power sanding, sawing, grinding, drilling, and other construction activities contains chemicals known to cause cancer, birth defects, or other reproductive harm. Some examples of these chemicals include:
 - Lead from lead-based paint.
 - Crystalline silica from bricks, cement, and other masonry products.
 - Arsenic and chromium from chemically-treated lumber.Your risk from these exposures varies depending on how often you perform this type of work. To reduce your exposure to these chemicals, work in a well-ventilated area, and use approved safety equipment, such as dust masks specifically designed to filter out microscopic particles.
- k) Use the "EMERGENCY STOP" if there is a risk of injury or death, accident or damage.
- l) Regularly inspect the condition of the safety labels. If the labels are illegible, they must be replaced.
- m) Please keep this manual available for future reference. If this device is passed on to a third party, the manual must be passed on with it.
- n) Keep packaging elements and small assembly parts in a place not available to children.
- o) Keep the device away from children and animals.

- p) If this device is used together with another equipment, the remaining instructions for use shall also be followed.
- q) Ensure that appropriate lighting is provided in the work area for safe operation.



Remember! When using the device, protect children and other bystanders.

2.3. Personal safety

- a) Do not use the device when tired, ill or under the influence of alcohol, narcotics or medication which can significantly impair the ability to operate the device.
- b) The machine may be operated by physically fit persons who are able to handle the machine, are properly trained, who have reviewed this operating manual and have received training in occupational health and safety.
- c) When working with the device, use common sense and stay alert. Temporary loss of concentration while using the device may lead to serious injuries.
- d) Use personal protective equipment as required for working with the device, specified in section 1 "Legend". The use of correct and approved personal protective equipment reduces the risk of injury.
- e) To prevent the device from accidentally switching on, make sure the switch is on the OFF position before connecting to a power source.
- f) Do not overestimate your abilities. When using the device, keep your balance and remain stable at all times. This will ensure better control over the device in unexpected situations.
- g) Do not wear loose clothing or jewellery. Keep hair, clothes and gloves away from moving parts. Loose clothing, jewellery or long hair may get caught in moving parts.
- h) If suction is to be connected to the device, check all connections and make sure they are tight. Using a dedusting system may reduce the risks associated with dust.
- i) Remove all adjusting tools or spanners before turning the device on. A tool or spanner left in the revolving part of the device may cause injury.
- j) The device is not a toy. Children must be supervised to ensure that they do not play with the device.
- k) Do not put your hands or other items inside the device while it is in use!
- l) Certain types of wood, press boards, and other materials can produce hazardous dust emissions when processed. Therefore, processing should always be done with an exhaust unit. The air speed at the connection points should be 20m/s. Ensure the machine and the exhaust unit are switched on simultaneously for proper operation.
- m) Keep hands clear of the blade area. Never reach past the blade to clear parts or scrap while the saw blade is running. Never saw freehand. Avoid awkward operations and hand positions where a sudden slip could cause your hand to contact the blade.

2.4. Safe device use

- a) Do not overload the device. Use the appropriate tools for the given task. A correctly-selected device will perform the task for which it was designed better and in a safer manner.
- b) Do not use the device if the "ON/OFF" switch does not function properly (does not switch the device on and off). Devices which cannot be switched on and off using the "ON/OFF" switch are hazardous, should not be operated and must be repaired.
- c) Make sure the plug is disconnected from the socket before attempting any adjustments, accessory replacements or before putting the device aside. Such precautions will reduce the risk of accidentally activating the device. Never remove the insert with the blade running.

- d) A machine under repair should be RED TAGGED to show it should not be used until the maintenance is complete.
- e) When not in use, store in a safe place, away from children and people not familiar with the device who have not read the user manual. The device may pose a hazard in the hands of inexperienced users.
- f) Keep the device in perfect technical condition. Before each use check for general damage, especially check moving components for cracked parts or elements, and for any other conditions which may impact the safe operation of the device. If damage is discovered, hand over the device for repair before use.
- g) Keep the device out of the reach of children.
- h) Device repair or maintenance should be carried out by qualified persons, only using original spare parts. This will ensure safe use.
- i) To ensure the operational integrity of the device, do not remove factory-fitted guards and do not loosen any screws.
- j) When transporting and handling the device between the warehouse and the destination, observe the occupational health and safety principles for manual transport operations which apply in the country where the device will be used.
- k) Avoid situations where the device stops working during use due to excessive loading. This may result in overheating of the drive elements and damage to the device.
- l) Do not touch articulated parts or accessories unless the device has been disconnected from the power source.
- m) Do not move, adjust or rotate the device in the course of work.
- n) Do not leave this appliance unattended while it is in use.
- o) Clean the device regularly to prevent stubborn grime from accumulating.
- p) The specified vibrations emission was measured using standard measurement methods. Vibrations emissions may change if the device is used in different surroundings.
- q) Do not work on two workpieces at the same time.
- r) The device is not a toy. Cleaning and maintenance may not be carried out by children without supervision by an adult person.
- s) Do not run the device when empty.
- t) It is forbidden to interfere with the structure of the device in order to change its parameters or construction.
- u) Keep the device away from sources of fire and heat.
- v) Always work with well-sharpened sawing tools to minimize the risk of wood kickback. Ensure the correct rotational direction is followed.
- w) Check that the sawing tool can rotate freely and does not come into contact with the limit stop, safety equipment, the workpiece, or any other objects.
- x) Keep clear of the kick-back zone to avoid injury.
- y) Feed wood uniformly and steadily into the sawing tool, ensuring there is no jerking or sudden movements. When working with hard wood or pieces that produce large amounts of dust, feed the material slightly more slowly.
- z) Never bend over the rotating sawing tool.

- aa) Always keep the machine guards in place for every operation for which they can be used. If any guards are removed for maintenance, DO NOT OPERATE the machine until the guards are reinstalled.
- bb) Use a support table or have a helper or "tailman" assist in taking stock away from the backside of the blade.
- cc) Before operation, check the alignment of the splitter, fence, and mitre slot to the blade.
- dd) Inspect the saw blade for cracks or missing teeth. Do not use a cracked or dull blade, or one with missing teeth or improper set. Ensure that the blade is securely locked on the arbour.
- ee) Always use the splitter, blade guard, push stick, and other safety devices for all operations where they can be used. For operations such as dadoing or molding, where the blade guard cannot be used, use feather boards, fixtures, and other safety devices. Reinstall the splitter and blade guard immediately after completing the operation that required their removal.
- ff) Ensure that the saw blade rotates clockwise when viewed from the motor side (left side) of the machine.
- gg) Do not attempt to saw boards with loose knots, nails, or other foreign materials on their surface. Do not attempt to saw twisted, warped, bowed, or "in wind" stock unless one edge has been jointed for guiding purposes before sawing.
- hh) Do not attempt to saw long or wide boards unsupported where spring or weight could cause the board to shift position.



ATTENTION! Despite the safe design of the device and its protective features, and despite the use of additional elements protecting the operator, there is still a slight risk of accident or injury when using the device. Stay alert and use common sense when using the device.

3. Use guidelines

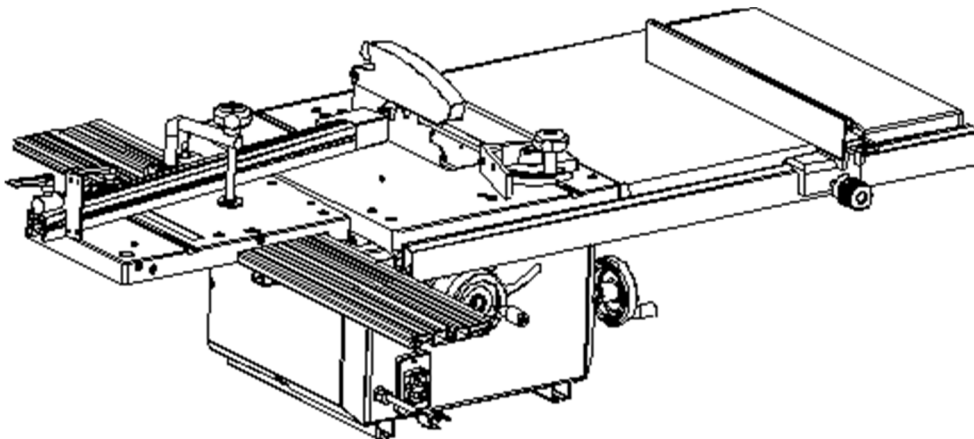

This product, built exclusively for woodworking, is designed for precision cutting and versatility, making it ideal for various woodworking and construction tasks.

The user is liable for any damage resulting from unintended use of the device.

3.1. Device description

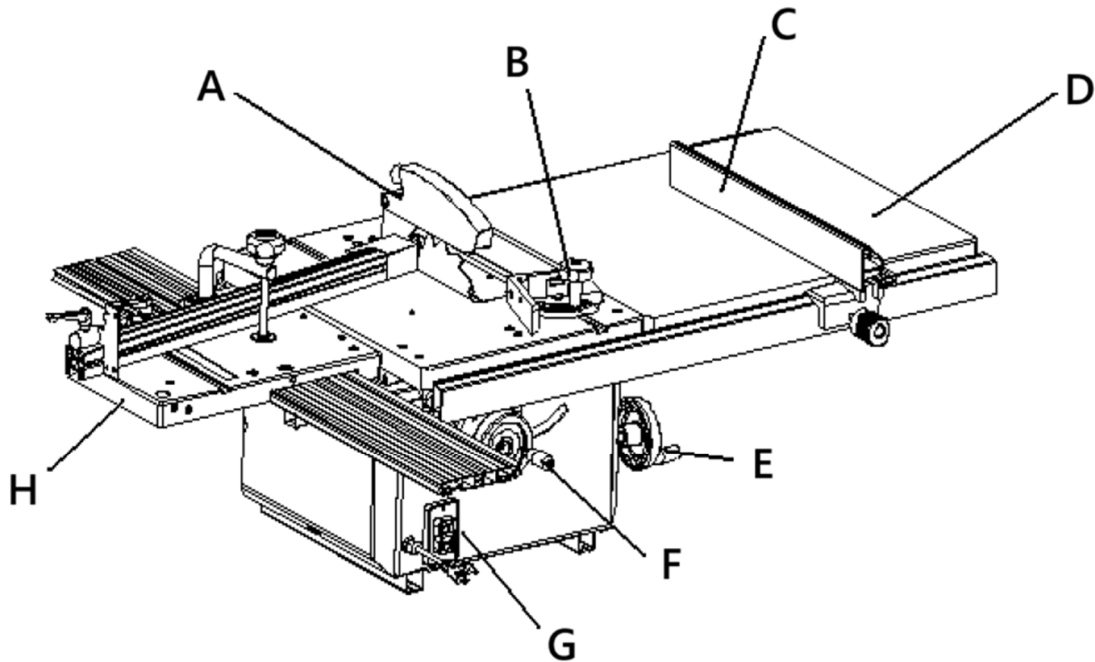

Fig.1

- A- Blade guard
- B- Mitre gauge
- C- Accu-fence
- D- Table extensions
- E- Tilting handwheel
- F- Raising handwheel
- G- Switch
- H- Moving table

3.2. Preparing for use

GROUNDING INSTRUCTIONS

1. This tool must be grounded during use to prevent electric shock. In case of a malfunction, grounding ensures a safe path for electric current, reducing the risk of shock.
2. The tool includes a power cord with a grounding conductor and a grounding plug, which must be connected to a properly installed and grounded outlet following local electrical codes.
3. Do not alter the plug. If it does not fit the available outlet, have a qualified electrician install the correct outlet.
4. Incorrectly connecting the grounding conductor may cause an electric shock. The grounding conductor is identifiable by its green insulation, with or without yellow stripes. If the power cord or plug needs repair or replacement, do not connect the grounding conductor to a live terminal.

5. If unsure about the grounding instructions or whether the tool is properly grounded, consult a qualified electrician or service technician.
6. Always use three-wire extension cords with three-prong grounding plugs and compatible three-pole receptacles.
7. Immediately repair or replace any damaged or worn cords.
8. When using an extension cord, ensure it is in good condition and capable of carrying the required current. An undersized cord can cause voltage drops, power loss, and overheating.

Use the recommended cord size based on length and amperage. If uncertain, choose a heavier gauge—the lower the gauge number, the thicker the cord.

Table: Minimum gauge for cord

Volts	Total length of cord in feet			
	120 V	25 ft.	50 ft.	100 ft.
240 V	50 ft.	100 ft.	200 ft.	300 ft.
	14 AWG	12 AWG	Not recommended	Not recommended

3.3. Assembling the device

UNPACKING

1. Unpack the saw and accessories from the carton and check for any damage. If damage is found, report it immediately to us.
2. Before continuing, carefully read the instruction manual to understand the correct procedures for assembly, maintenance, and safety.

INSTALLATION INSTRUCTIONS

1. Remove the Table Insert

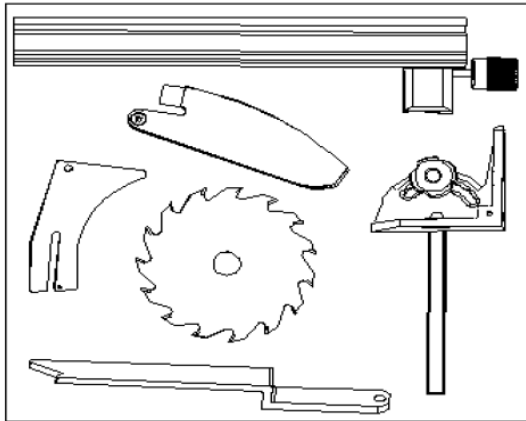

Fig.2

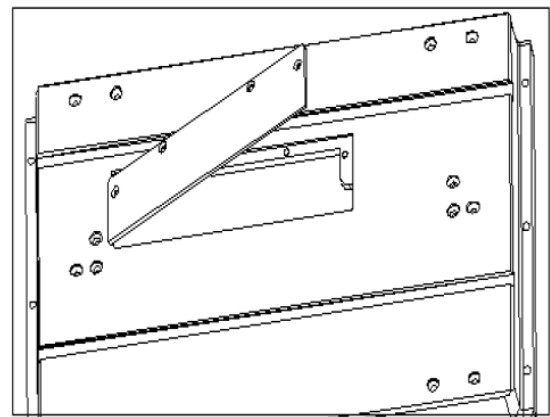

Fig.3

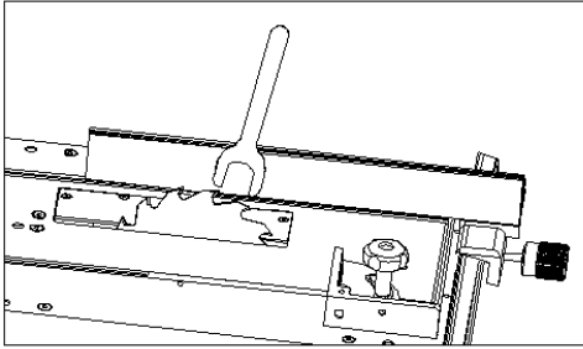

Fig.4

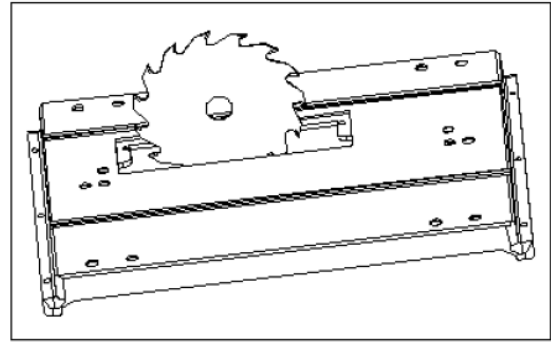

Fig.5

- 1) Block the spindle using the current sawing tool and remove the flange (Fig. 3, Fig. 4). Ensure all components are thoroughly cleaned before reassembly.
- 2) When replacing the saw blade, ensure the teeth are positioned in the correct direction.
- 3) Reinstall the various connection elements (Fig. 5).

2. Mounting and Adjusting the Splitting Wedge

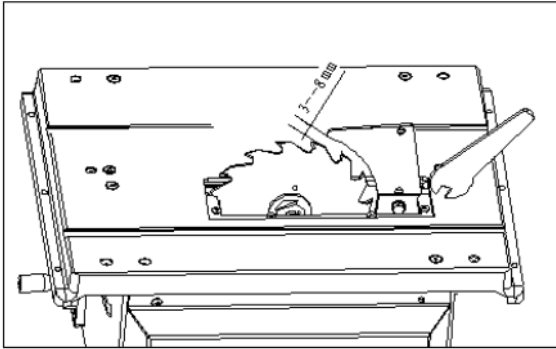

Fig.6

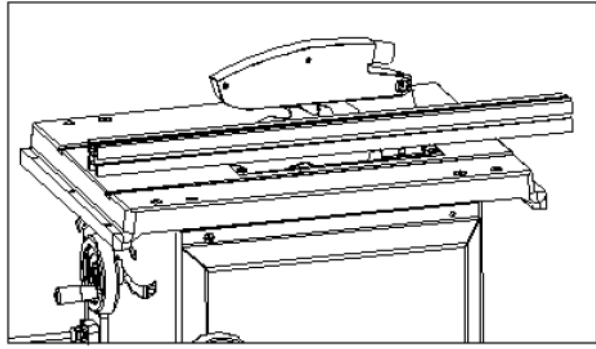

Fig.7

- 1) Loosen the flange base using a 13 mm wrench and insert the splitting wedge.
- 2) Adjust the splitting wedge, ensuring a distance of approximately 3 mm from the saw blade (Fig. 6).
- 3) Securely fasten the splitting wedge with a screw.
- 4) Verify that the splitting wedge is parallel to the saw blade using the table insert (Fig. 7).

3. Adjusting the Longitudinal Limit Stop

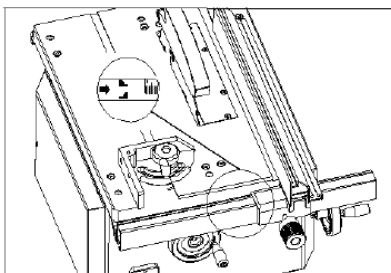

Fig.8

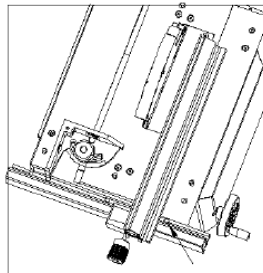

Fig.9

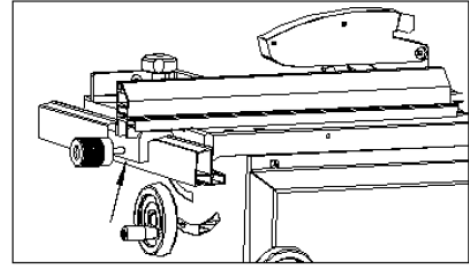

Fig.10

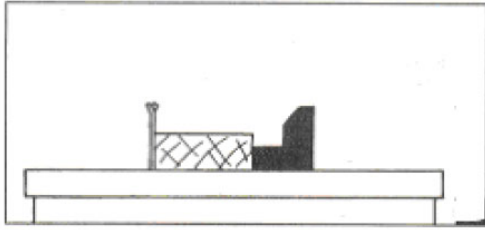

Fig.11

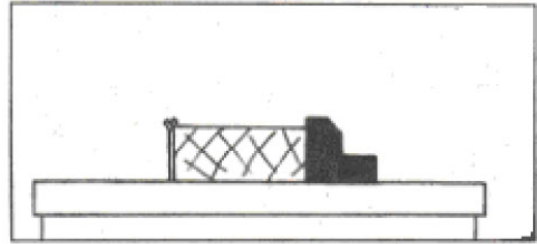

Fig.12

- 1) Ensure the longitudinal limit stop is precisely parallel to the saw blade.
- 2) Set the longitudinal limit stop to zero on the guide rail scale, then align it precisely with the saw blade.
- 3) Secure the setting using the left hexagonal socket screw (Fig. 8). This procedure should be repeated each time the saw blade is replaced.
- 4) Use the right guide notch as a visual reference to confirm parallel alignment (Fig. 9, Fig. 10).
- 5) To adjust for flat workpieces, loosen the lower M8 clamp screw in the limit stop holder (Fig. 11, Fig. 12), allowing the longitudinal limit stop to be moved or turned.
- 6) The longitudinal limit stop can be positioned on either the left or right side of the saw blade.



NOTICE! Regularly check that the longitudinal limit stop remains parallel for precise cutting.

4. Adjusting the Cutting Height

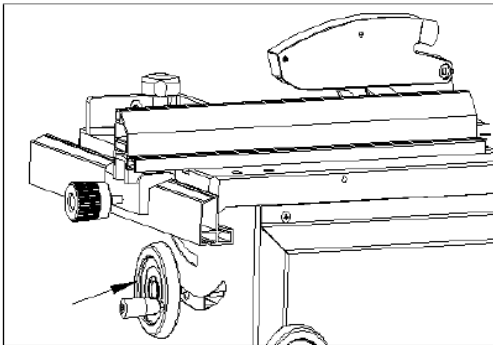

Fig.13

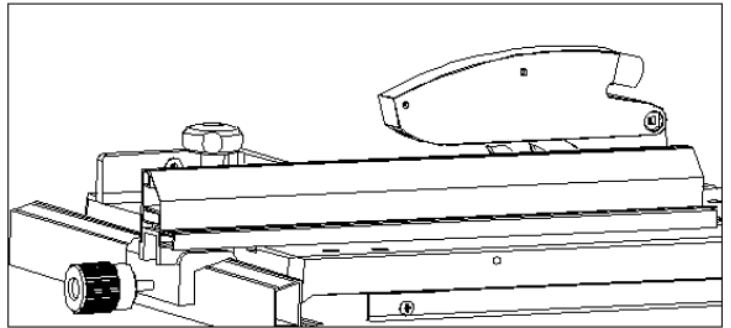

Fig.14

- 1) Adjust the cutting height using the hand wheel (Fig. 13).
- 2) Ensure the saw blade teeth protrude slightly beyond the workpiece being cut (Fig. 14).

5. Adjusting the Pivot

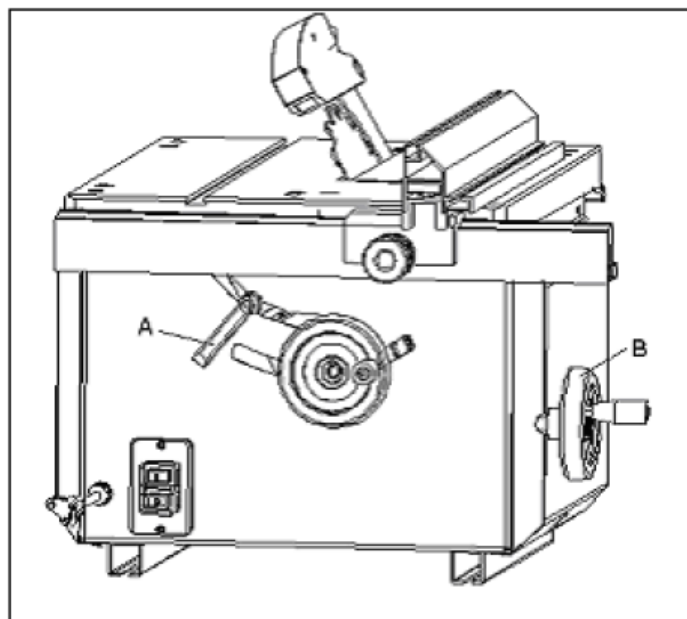

Fig.15

- 1) Release lock knob A (Fig. 15).
- 2) Lower the saw blade up to 45° by applying pressure to hand wheel B (Fig. 15).
- 3) Adjust the height as needed by gradually releasing pressure on the hand wheel.



NOTICE! At pivot angles of 30° or more, reduce the maximum height adjustment by 10 mm.

3.4. Device use

WORKING WITH THE CIRCULAR TABLE SAW

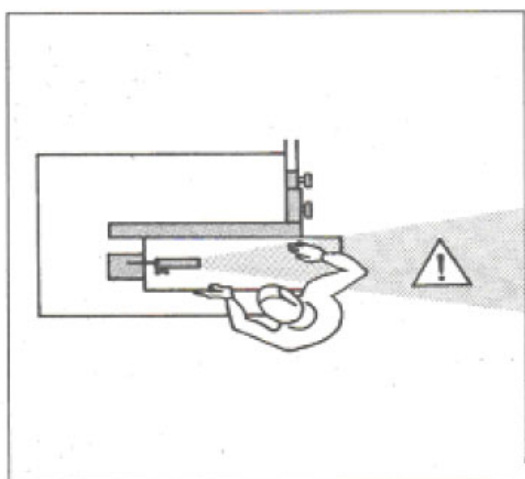

Fig. 16

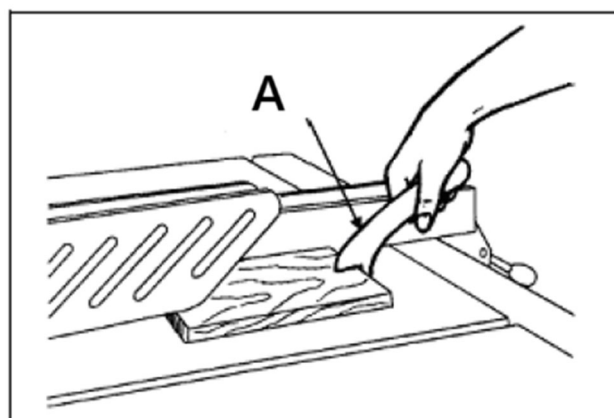

Fig. 17

A- Push stick for smaller workpieces

1. Use only sharp, uniform, and properly tensioned circular saw blades.
2. Securely adjust and fasten the splitting wedge.
3. Adjust the protective cover according to the thickness of the saw blade.

4. Maintain the recommended working stance and stay out of the danger zone (Fig. 16).
5. Feed the workpiece with both hands, using the feeding rod near the saw blade until it has passed the splitting wedge.
6. Secure longer workpieces to prevent flipping after cutting, using a table extension if necessary (Fig. 17).

CUTTING NARROWER WORKPIECES, EDGES, AND STRIPS

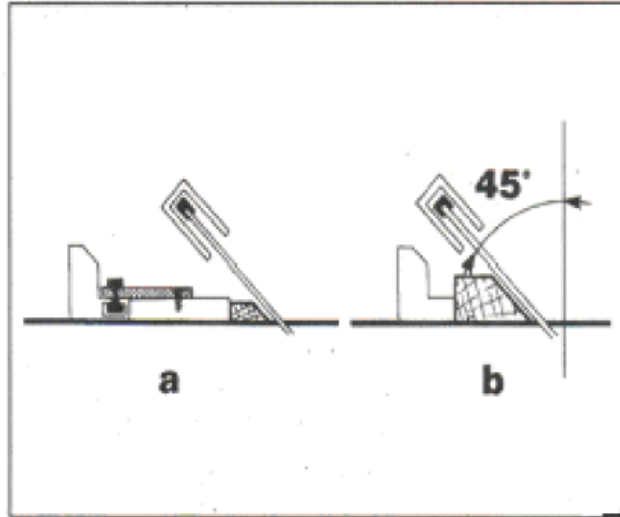

Fig. 18

1. For workpieces narrower than 120 mm, use the flat edge of the longitudinal limit stop.
2. If needed, use a parallel intermediate piece for support.
3. Secure longer workpieces to prevent flipping after cutting, using a table extension (Fig. 18).

DIAGONAL LIMIT STOP

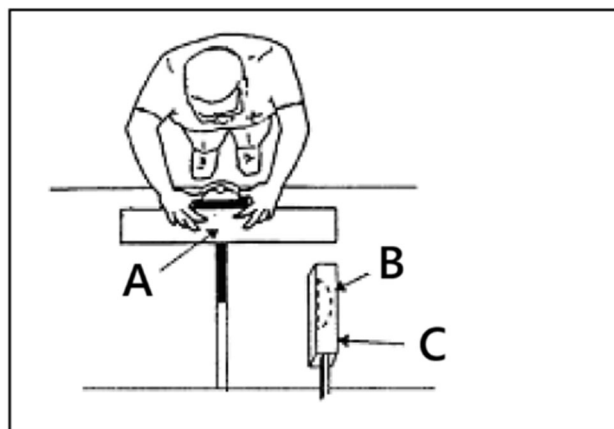

Fig. 19

- A- Workpiece held firmly
- B- Blade set at an angle less than 90° for bevel cut
- C- Guard

1. The diagonal limit stop can be installed on either the left or right side of the saw blade in the T-groove.
2. It allows for precise diagonal cuts between 90° and 45° through adjustable positioning (Fig. 19).

3. The 90° orientation of the two supporting surfaces enables stable diagonal positioning.

CROSS-CUTTING NARROWER WORKPIECES

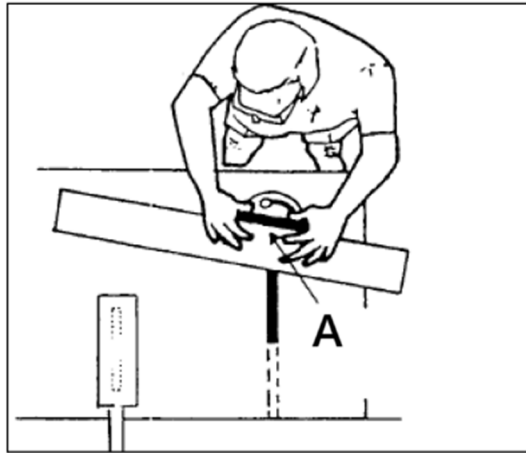

Fig. 20

A- Lock the miter gauge and hold the workpiece firmly

1. Adjust the guard rail so that the workpiece cannot contact the upwards rotating part of the saw blade.
2. Feed workpieces only using a cross limit stop or a cross feeder (Fig. 20).



CAUTION! Do not remove debris from the sawing tool area with your hands.

ANGULAR LIMIT STOP

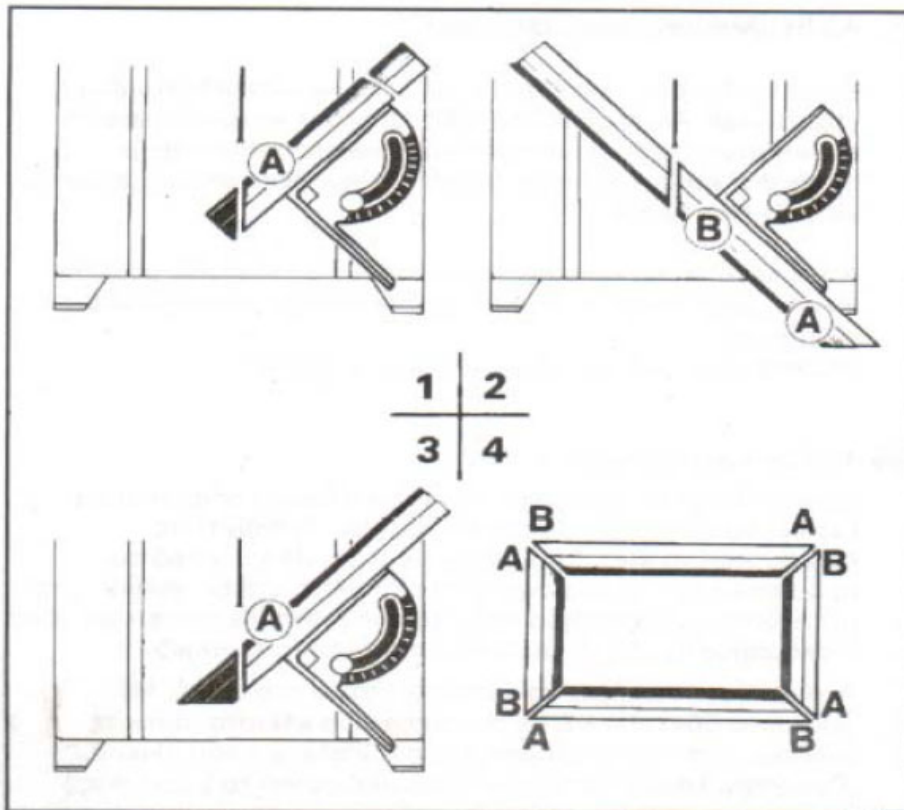

Fig. 21

1. The angular limit stop can be inserted into the machine table T-grooves on either side of the saw blade.
2. Cross-cuts can be made at any angle by pivoting the limit stop.
3. The 90° milled angular limit stop is ideal for precise miter cuts, as shown in the frame cutting example (Fig. 21).

3.5. Cleaning and maintenance

- a) Unplug the mains plug and allow the device to cool completely before each cleaning, adjustment or replacement of accessories, or if the device is not being used.
 - Wait for the rotating elements to stop.
- b) Always unplug the device before cleaning or putting it away.
- c) Use only non-corrosive cleaners to clean the surface.
- d) After cleaning the device, all parts should be dried completely before using it again.
- e) Store the unit in a dry, cool place, free from moisture and direct exposure to sunlight.
- f) Do not spray the device with a water jet or submerge it in water.
- g) The device must be regularly inspected to check its technical efficiency and spot any damage.
- h) Use a soft, damp cloth for cleaning.
- i) Do not use sharp and/or metal objects for cleaning (e.g. a wire brush or a metal spatula) because they may damage the surface material of the appliance.
- j) Do not clean the device with an acidic substance, agents of medical purposes, thinners, fuel, oils or other chemical substances because it may damage the device.
- k) Regularly lubricate the mechanical parts: threaded rods, gears, driving chains, hinges, sliding parts, etc.

DISPOSING OF USED DEVICES

Do not dispose of this device in municipal waste systems. Hand it over to an electric and electrical device recycling and collection point. Check the symbol on the product, instruction manual and packaging. The plastics used to construct the device can be recycled in accordance with their markings. By choosing to recycle you are making a significant contribution to the protection of our environment.

Contact local authorities for information on your local recycling facility.

TROUBLESHOOTING

1. Machine vibrates:

- Clamping levers for height and diagonal adjustment are not securely tightened.
- The sawing tool is not properly fastened.

2. Cuts are not clean/wood is burned:

- The sawing tool is dull.
- The sawing tool is incorrectly installed.

3. Rapid sawing tool wear:

- The sawing tool has been improperly sharpened.
- Wood contains contaminants such as cement, sand, or nails.

4. Motor overheats:

- If the motor is too hot to touch or shuts off repeatedly, have it inspected by a qualified electrician.

5. Machine stops running:

- Overloading due to excessive feed rate or a dull sawing tool.

6. Wood lifts at the rear of the saw blade:

- Longitudinal limit stops are not parallel.
- The splitting wedge is misaligned or too weak.

7. Difficulty adjusting spindle height:

- Clean and lubricate the threaded rod, gears, and slide tracks.
- Check the clamping lever for proper function.

8. Miscellaneous issues:

- Unusual bearing noises: Inspect and replace bearings if needed.
- V-belt tension: Check and adjust the tension if necessary (accessible by removing the exhaust cover).

3.6. Wiring diagram

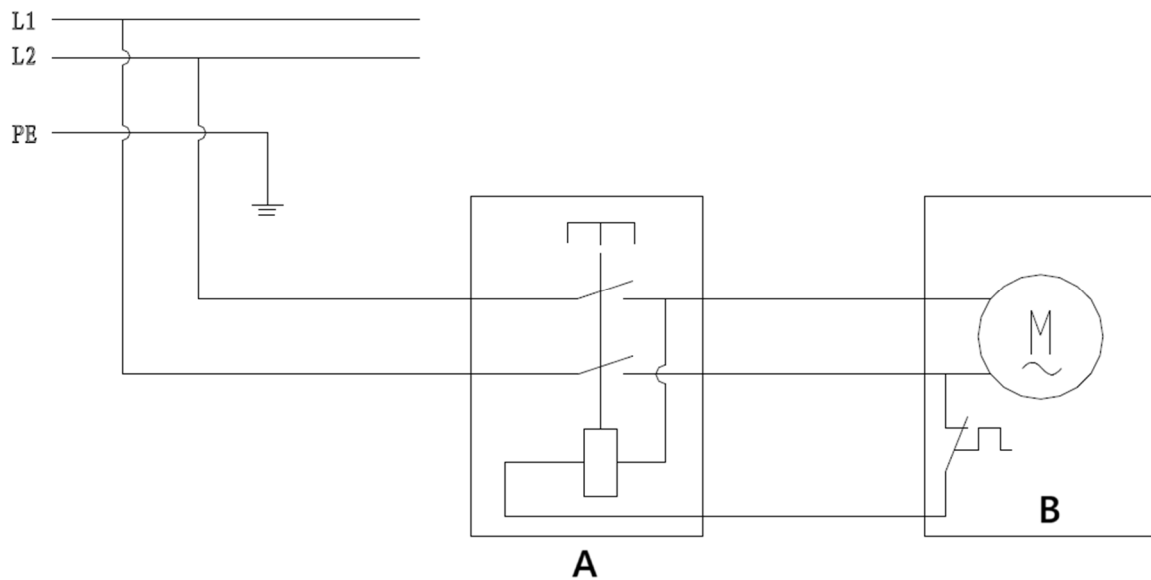

A- Electromagnetic switch

B- Motor 1.1kw

3.7. Parts diagram

PARTS DIAGRAM A

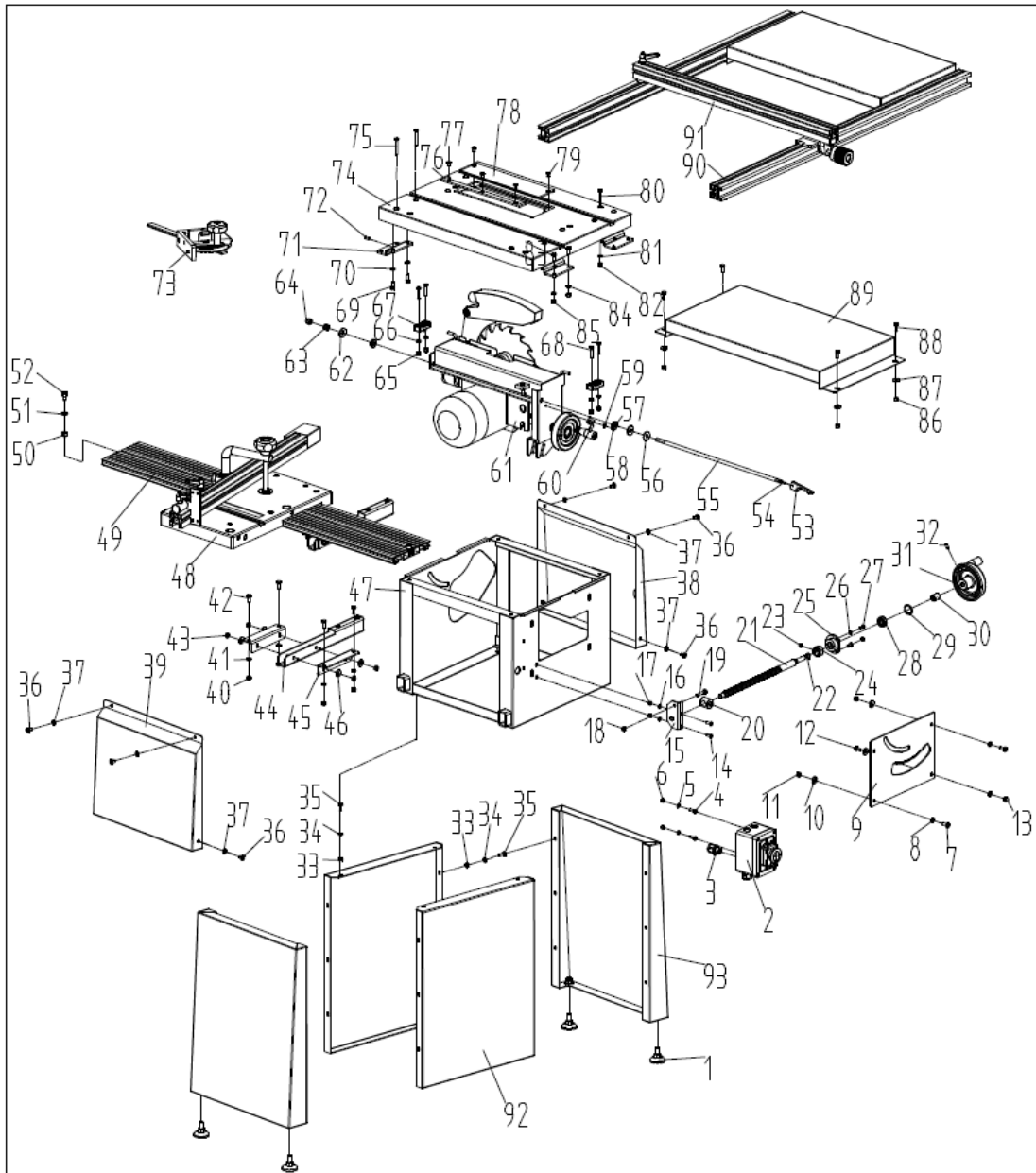

NO.	DESCRIPTION	QTY.	NO.	DESCRIPTION	QTY.
1	Foot	4	2	Switch assembly	1
3	Metric bushing M16	2	4	Screw M5X16	2
5	Washerφ5	2	6	Hex nut M5	2
7	Screw M6X16	3	8	Washerφ6	4
9	Saw faceplate	1	10	Large washer 6	4
11	Hex nut M6	4	12	Hex bolt M6X12	1
13	Hex nut M6	1	14	Screw M5X14	2
15	Threaded shaft support	1	16	Washerφ5	2
17	Locking nut M5	2	18	Hex nut M6	1
19	Hex bolt M6X30	1	20	Threaded nut	1
21	Threaded shaft	1	22	C ring φ10	1
23	Set screw M8X6	1	24	Limitative bush	2
25	Bearing rack	1	26	Washerφ5	3
27	Hex bolt M5X10	3	28	Bearing 6000	1
29	"C" ring φ26	1	30	Space bush	1
31	Hand wheel	1	32	Set screw M6X12	1

33	Hex nut M6	16	34	Washerφ6	16
35	Hex bolt M6X16	16	36	Screw M6X10	8
37	Washerφ6	8	38	Protective cover	1
39	Protective cover	1	40	Hex nut M6	8
41	Washerφ6	8	42	Hex bolt M6X16	8
43	Hex nut M6	8	44	Outstretched arm	2
45	Angle iron	4	46	Large washer 6	8
47	Box assembly	1	48	Sliding table assembly	1
49	Guide rail	1	50	Hex nut M8	2
51	Washerφ8	2	52	Screw M8X10	2
53	Locking handle	1	54	Pin 3X12	1
55	Locking shaft	1	56	Large washer 8	2
57	Space bush	2	58	Screw M4X6	1
59	Tooth washer 4	1	60	pointer	1
61	Saw assembly	1	62	Large washer 8	1
63	locking nut M8	1	64	Hex nut M8	1
65	Locking nut M6	4	66	Washerφ6	4
67	Supporting rear	2	68	Screw M6X30	4
69	Screw M6X16	8	70	Washerφ6	8
71	Supporting plate	4	72	Screw M6X12	4
73	MITER GAUGE	1	74	Main table	1
75	Screw M6X45	4	76	Aluminous plate	1
77	Screw M4X10	3	78	Insert	1
79	Screw M6X10	2	80	Screw M6X45	4
81	Washerφ6	4	82	Locking nut M6	4
83	Hex bolt M6X16	8	84	Washerφ6	8
85	Hex nut M6	8	86	Hex nut M6	8
87	Large washer 6	8	88	Hex bolt M6X16	8

PARTS DIAGRAM B

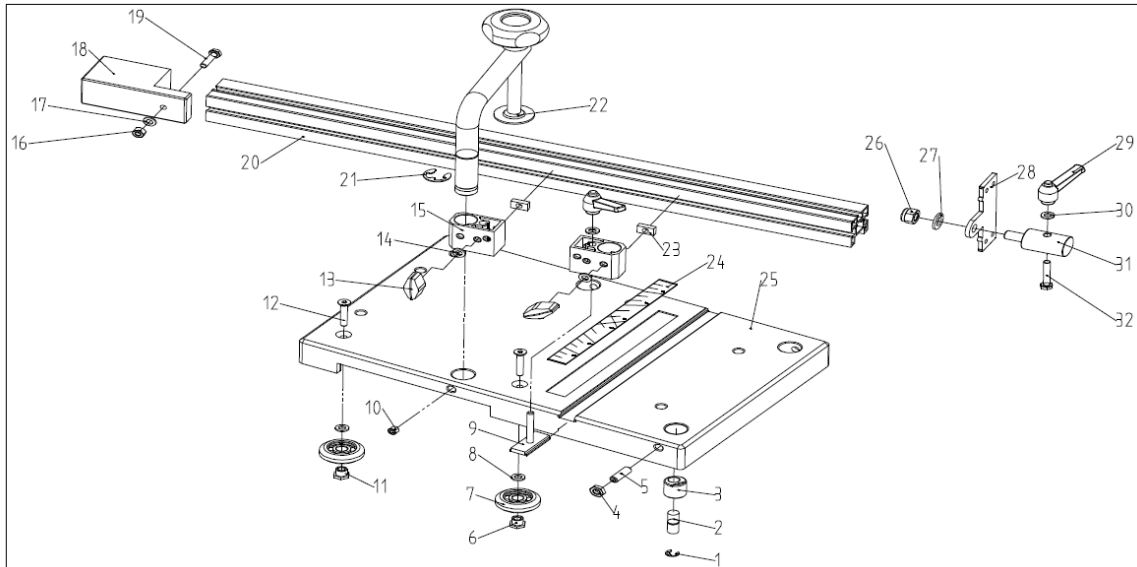

NO.	DESCRIPTION	QTY.	NO.	DESCRIPTION	QTY.
1	C-shaped ring	1	2	sliding axle	1
3	Eccentric bush	1	4	Hex thin nut M8	1
5	Set screw M8X25	1	6	Eccentric nut	2
7	Trolley	4	8	Washer φ6	4

9	T-shaped bolt	1	10	Set screw M8X10	1
11	Homocentric nut	2	12	Socket countersunk screw M6X35	4
13	Rhombic handgrip	2	14	Washer ϕ 6	3
15	Connecting block	2	16	Hex nut M6	1
17	Washer ϕ 6	1	18	wood block	1
19	Hex bolt M6X25	1	20	Angle fence	1
21	"E" ring ϕ 12	1	22	Press handle	1
23	Square toes nut	2	24	Angle ruler	1
25	Sliding table	1	26	Locking nut M10	1
27	Washer ϕ 10	1	28	Turing plate	1
29	Small handgrip	2	30	Washer ϕ 6	1
31	Locating pole	1	32	Hex bolt M6X35	1

PARTS DIAGRAM C

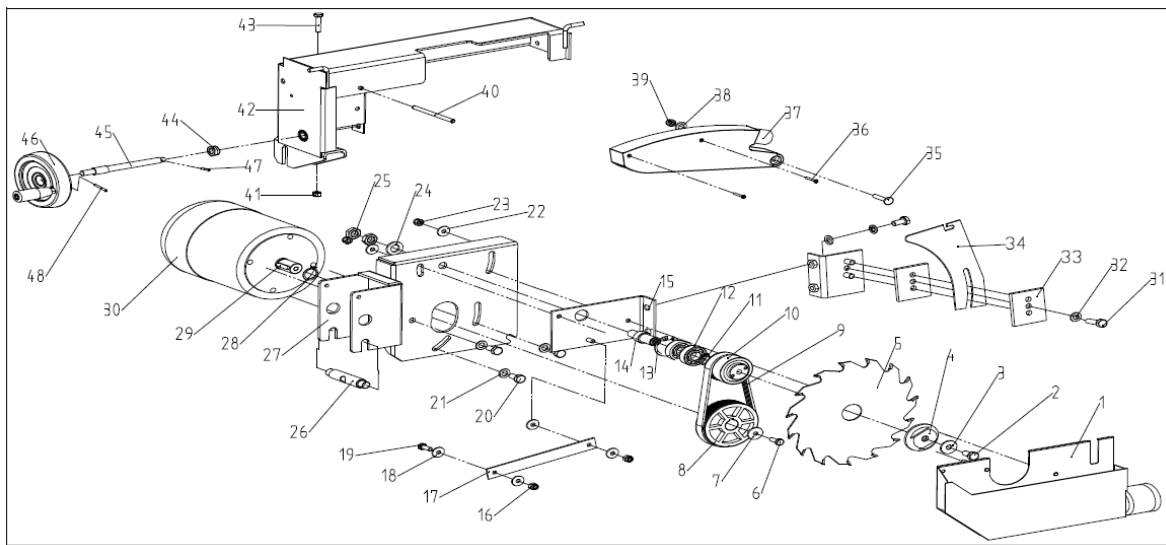

NO.	DESCRIPTION	QTY.	NO.	DESCRIPTION	QTY.
1	Dust collector	1	2	Hex bolt M8X16	1
3	Large washer ϕ 8	1	4	Platen	1
5	saw blade	1	6	Hex bolt M6X16	1
7	Very large washer ϕ 6	1	8	Motor pulley	1
9	Cuneal belt	1	10	Driven pulley	2
11	"C" ring ϕ 15	1	12	Bearing 6202	2
13	"C" ring ϕ 35	1	14	Saw axis	1
15	Parallel plate	1	16	Locking nut M6	2
17	Connecting plate	1	18	Large washer ϕ 6	4
19	Hex bolt M6X16	1	20	Hex bolt M8X16	3
21	Washer ϕ 8	3	22	Large washer ϕ 6	2
23	Locking nut M6	2	24	Washer ϕ 12	1
25	Hex thin nut M12	2	26	Turning pole	1
27	Motor rack	1	28	"C" ring ϕ 19	1
29	Key 6X25	1	30	Motor	1
31	Hex bolt M8X25	1	32	Washer ϕ 8	1
33	Clamp plate	2	34	Riving wedge	1
35	Bolt M6X30	1	36	Screw M3X20	2
37	Exterior dust collector	1	38	Washer ϕ 6	1
39	Locking nut M6	1	40	Spring pin 6X85	1
41	Hex nut M6	1	42	Turning support	1

43	Hex bolt M6X30	1	44	Locking nut M10	1
45	Bolt shaft	1	46	Hand wheel	1
47	Spring pin 3X16	1	48	Spring pin 3X25	1

PARTS DIAGRAM D

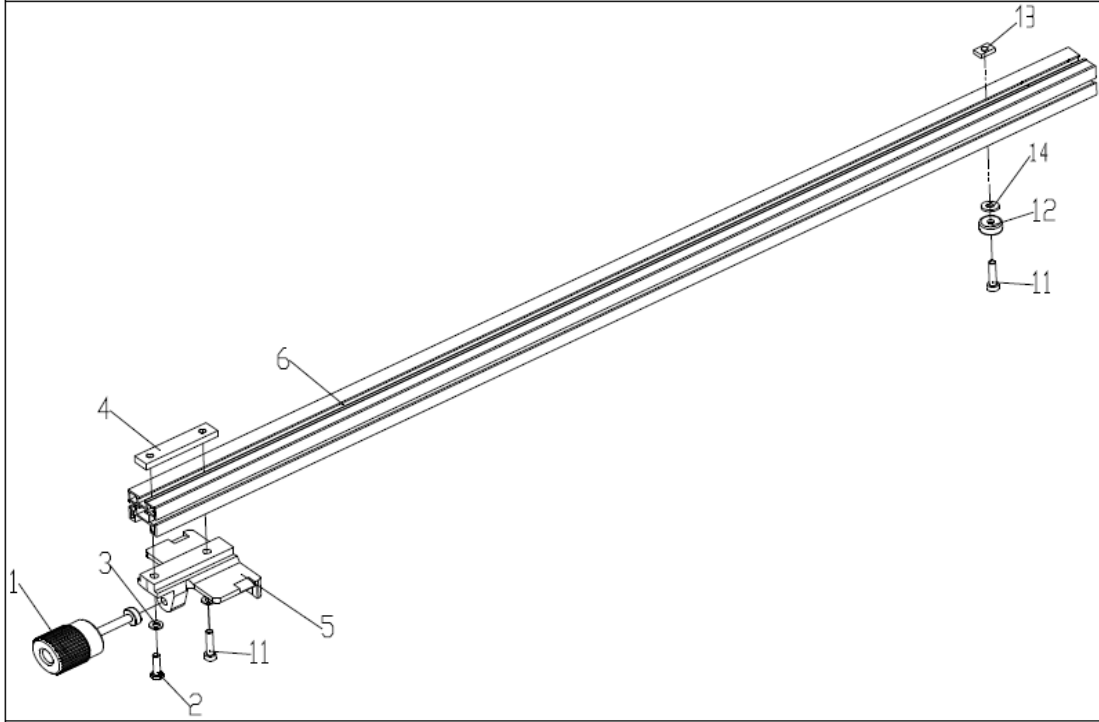

NO.	DESCRIPTION	QTY.	NO.	DESCRIPTION	QTY.
1	Locking handle	1	2	Hex bolt M6X25	1
3	Washer φ6	1	4	Fixing plate	1
5	Locking bracket	1	6	Long fence	1
11	Socket cap screw M6X30	2	12	Rubber tray	1
13	Hex nut M6	1	14	Large erφ6	1

PARTS DIAGRAM E

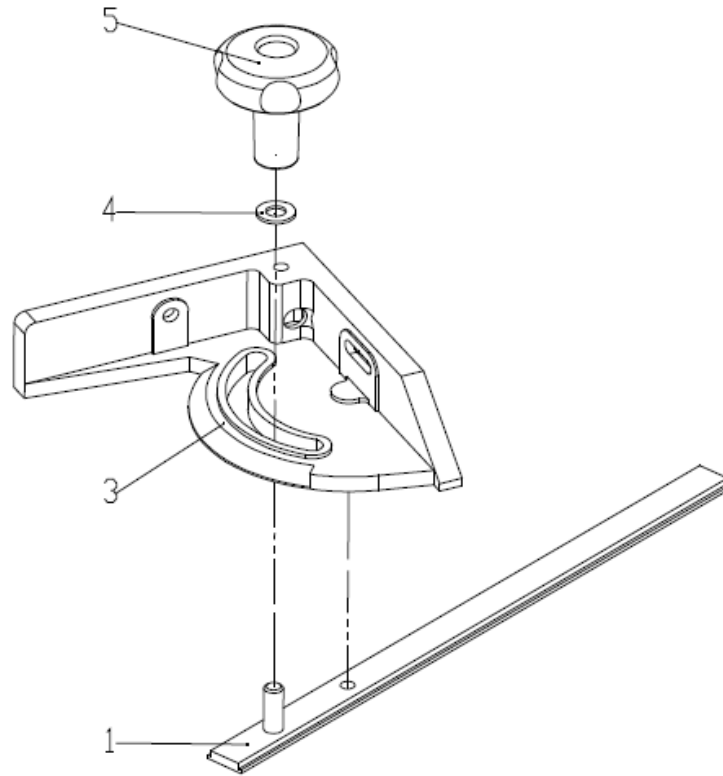

NO.	DESCRIPTION	QTY.	NO.	DESCRIPTION	QTY.
1	T-shaped plate	1	4	Washer $\phi 8$	1
3	Miter gauge	1	5	Long handle	1

Umwelt – und Entsorgungshinweise

Hersteller an Verbraucher

Sehr geehrte Damen und Herren,

gebrauchte Elektro – und Elektronikgeräte dürfen gemäß europäischer Vorgaben **[1]** nicht zum unsortierten Siedlungsabfall gegeben werden, sondern müssen getrennt erfasst werden. Das Symbol der Abfalltonne auf Rädern weist auf die Notwendigkeit der getrennten Sammlung hin. Helfen auch Sie mit beim Umweltschutz. Sorgen Sie dafür, dieses Gerät, wenn Sie es nicht mehr weiter nutzen wollen, in die hierfür vorgesehenen Systeme der Getrenntsammlung zu geben.



In Deutschland sind Sie gesetzlich **[2]** verpflichtet, ein Altgerät einer vom unsortierten Siedlungsabfall getrennten Erfassung zuzuführen. Die öffentlich – rechtlichen Entsorgungsträger (Kommunen) haben hierzu Sammelstellen eingerichtet, an denen Altgeräte aus privaten Haushalten ihres Gebietes für Sie kostenfrei entgegengenommen werden. Möglicherweise holen die rechtlichen Entsorgungsträger die Altgeräte auch bei den privaten Haushalten ab.

Bitte informieren Sie sich über Ihren lokalen Abfallkalender oder bei Ihrer Stadt – oder Gemeindeverwaltung über die in Ihrem Gebiet zur Verfügung stehenden Möglichkeiten der Rückgabe oder Sammlung von Altgeräten.

[1] RICHTLINIE 2002/96/EG DES EUROPÄISCHEN PARLAMENTS UND DES RATES
ÜBER ELEKTRO – UND ELEKTRONIK – ALTGERÄTE

[2] Gesetz über das Inverkehrbringen, die Rücknahme und die umweltverträgliche Entsorgung
von Elektro – und Elektronikgeräten (Elektro – und Elektronikgerätegesetz – ElektroG).

Utylizacja produktu

Produkty elektryczne i elektroniczne po zakończeniu okresu eksploatacji wymagają segregacji i oddania ich do wyznaczonego punktu odbioru. Nie wolno wyrzucać produktów elektrycznych razem z odpadami gospodarstwa domowego. Zgodnie z dyrektywą WEEE 2012/19/UE obowiązującą w Unii Europejskiej, urządzenia elektryczne i elektroniczne wymagają segregacji i utylizacji w wyznaczonych miejscach. Dbając o prawidłową utylizację, przyczyniasz się do ochrony zasobów naturalnych i zmniejszasz negatywny wpływ oddziaływania na środowisko, człowieka i otoczenie. Zgodnie z krajowym prawodawstwem, nieprawidłowe usuwanie odpadów elektrycznych i elektronicznych może być karane!

For the disposal of the device please consider and act according to the national and local rules and regulations.

CONTACT

expondo Polska sp. z o.o. sp. k.

ul. Nowy Kisielin – Innowacyjna 7
66-002 Zielona Góra | Poland, EU

e-mail: info@expondo.com